

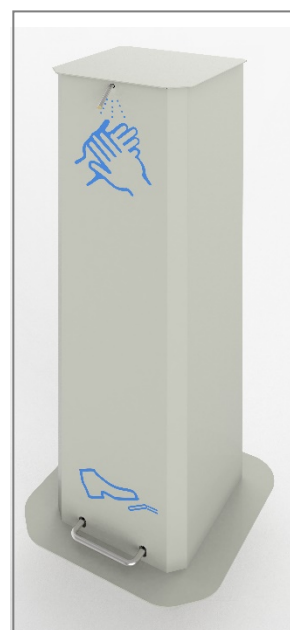

KDM



KDS



KDM



KDS

KDS Column XXXP 020329 and KDM Expanded Column XXXP 020328

Purpose

Stationary column for hand sanitizing. In current worldwide epidemiological situation maintaining cleanliness and hand disinfection are of particular importance, especially in public spaces. Availability to the cleaning products has to be easy and sterile.

- **KDS Column** – foot-operated dosing of hand sanitizer,
- **KDM Column**- foot-operated dosing of hand sanitizer, moreover possibility to dispense disposable gloves from the carton or the hook as well as dangles the bag for used gloves. Possibility to paint columns with bacteriolytic powders – on special order.

KDS Technical Parameters:

- ✓ 1 column with measurement 1100 x 300 x 300 mm (height x width x depth)
- ✓ 1 unwinding base 440 x 400 mm (width x height)
- ✓ 1 liquid pump with atomizing jet
- ✓ 1 heaver to foot-operated dosing hand sanitizer
- ✓ 4 raw-plugs for mounting
- ✓ made from galvanized steel 1-3mm painted with polyester powder adapted for external conditions. The product contains stainless mechanical elements
- ✓ weight without packaging ~20 kg

KDM Technical Parameters:

- Equipped as KDS and additionally:
- ✓ 1 shelf for disposable gloves in cartons: 2 cartons 130 x 250 x 60 or 1 carton 130 x 250 x 80 (height x width x depth) with special charging hole
- ✓ 1 rack from the inside for ripped disposable gloves, with charging hole
- ✓ 1 handle for trash bag with capacity ~40 l with maximum measurement 600 x 300 x 295 Weight without packaging ~22 kg.

Packaging

1 package with measurement 1150 x 460 x 460 mm
Column is delivered as “ready to use”. There is possibility to fix the column to the ground with raw-plugs which are in a set.

KDS Column to hand sanitizing

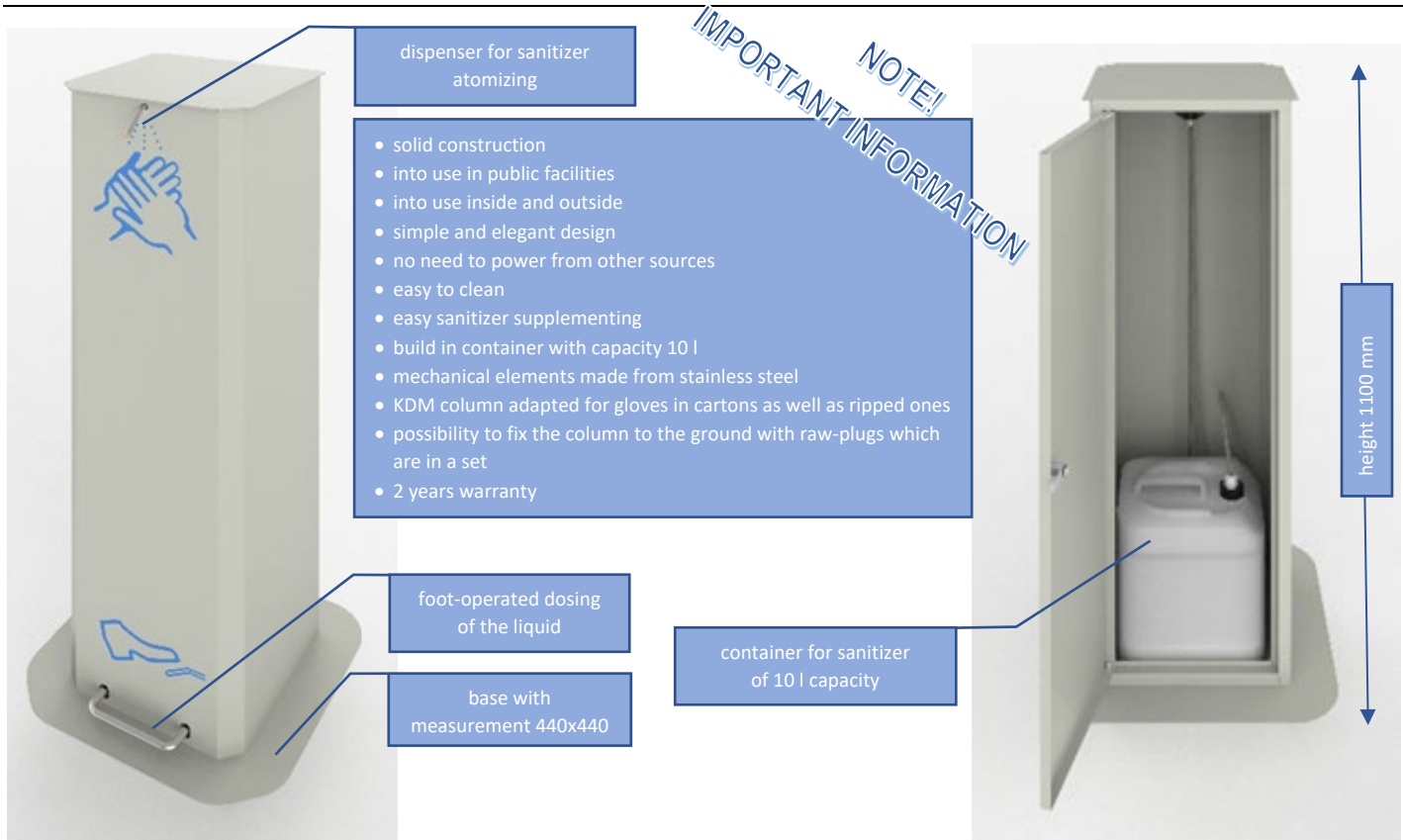

KDM Column to hand sanitizing

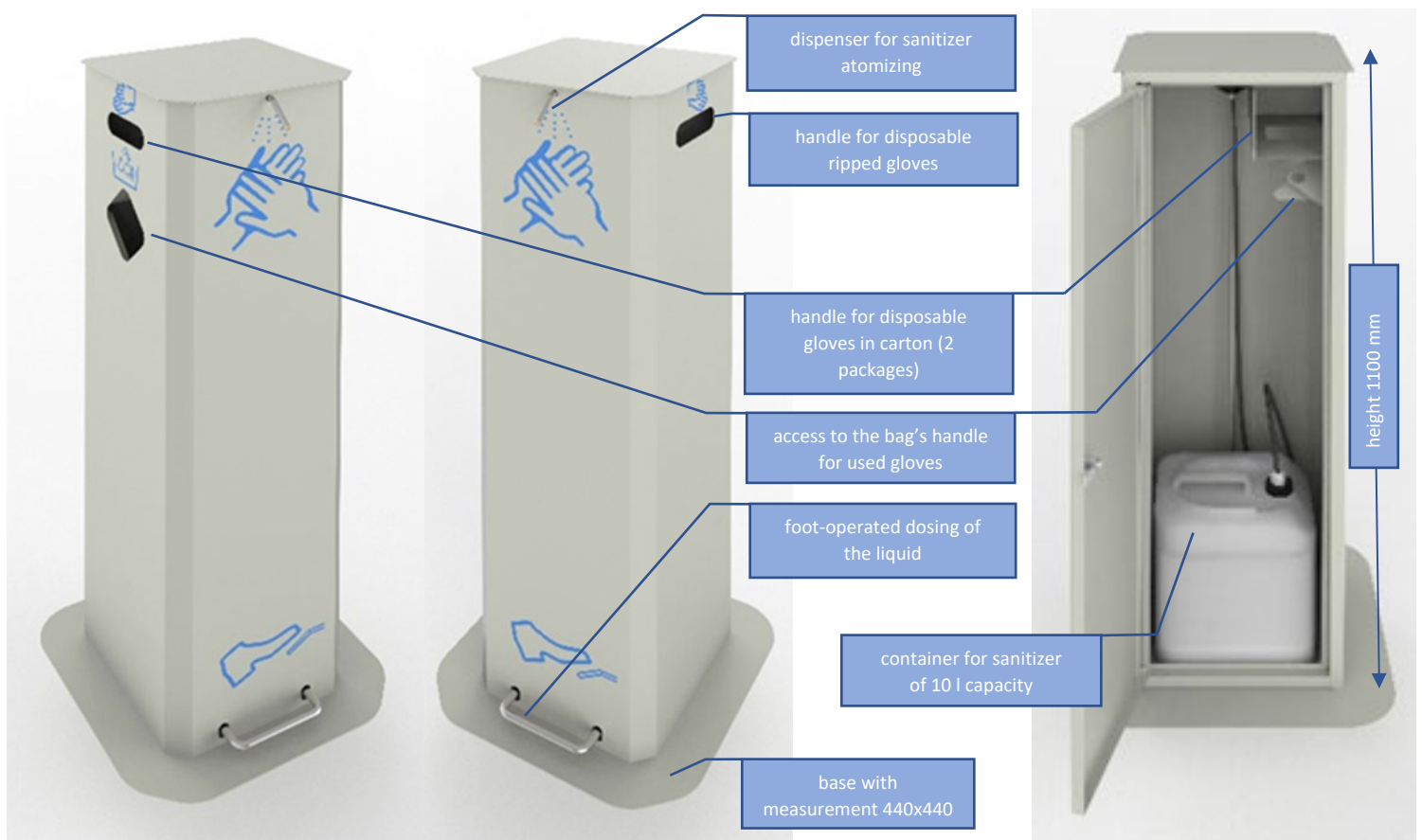

Omega Ekspress SIA

LV40003402577

Biroja adrese: Lāčplēša 125, LV-1003, Rīga

www.city-office.lv

info@city-office.lv